



MANUAL RELEASE INSTRUCTIONS *Most common*

Swing Gate Operator

AMICO & AXO

The AMICO & AXO worm drive swing gate operators have a manual release lock beneath a hatch on the top of the motors.

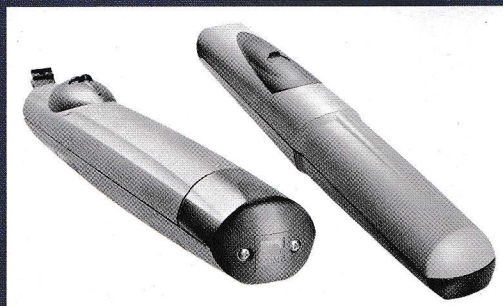

TO MANUALLY RELEASE THE GATES:



ALWAYS isolate the power supply as instructed by your installer (even during a power cut).



Release any additional locking device fitted to the gate (eg. electric lock etc).

A

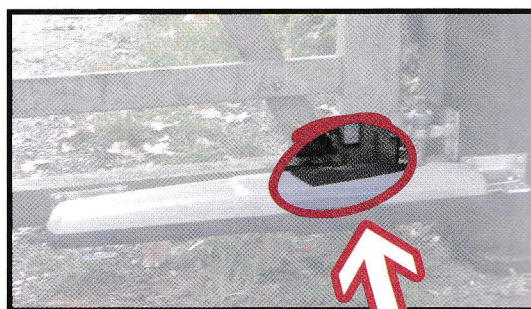

INSTRUCTIONS



- 1** Slide open the hatch covering the lock.
- 2** Insert the 3-sided triangular key **A** into lock and turn until it clicks.

With your other hand firmly open the gate. The gate should be manually released. Now fully open the gate carefully at the same speed as the automatic operator.

To re-engage, close the gate and turn the key back to its original position. Attempt to manually move the gate to ensure it is fully engaged.

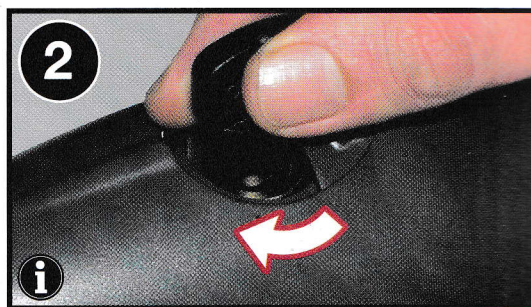
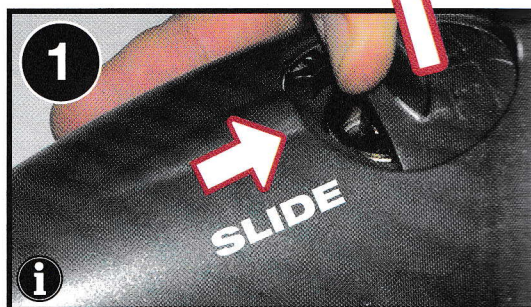

AMICO & AXO Basic Maintenance

Hints & Tips



- Slide back manual release cover & spray locking mechanism with suitable penetrating lubricant.
- Lubricate gate hinges.
- Manually release the gates at least once per month.